

AC Current & Voltage Transmitters SLIMPACK

TX-AC

FEATURES

- Input modules for AC Voltage 0~150V, 0~300V, 0~500V or AC Current 0 ~ 1A, 0~5A
- Output V & mA selected via terminals and 0~5V / 0~10V / 1~5V / 4~20mA / 0~20mA selected via dip switches
- Dual signal output available in 22.5 mm thin profile
- Wide power supply range AC & DC 22 ~ 265V
- CE Approved



ORDER CODING

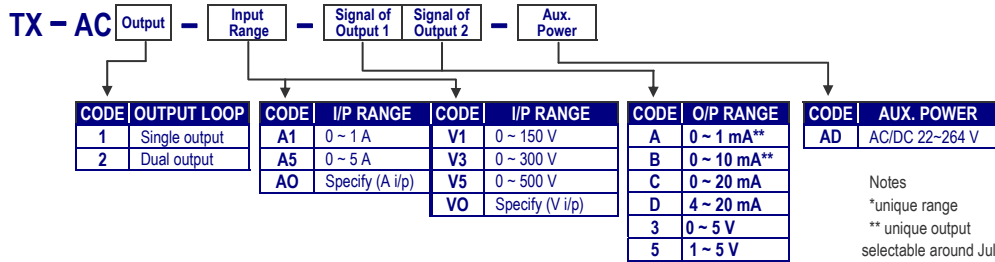

TECHNICAL DATA

Signal input

	Input Range	Input Burden	Input Frequency
Aac	0 ~ 1 A	≤ 0.10VA	50 Hz ± 3 Hz 60 Hz ± 3 Hz
	0 ~ 5 A		
Vac	0 ~ 150 V	≤ 0.15VA	
	0 ~ 300V		
	0 ~ 500V		

Analogue output (change output range by dip-switch)

Output Range	Load Resistance	Output Signal (Selected by terminals)
0 ~ 20mAdc	≤ 600Ω	Output 1: Io(mA output by terminal 9+ & 8-)
4 ~ 20mAdc	≤ 600Ω	Output 1: Vo(V output by terminal 7+ & 8-)
0 ~ 10Vdc	≤ 500Ω	Output 2: Io(mA output by terminal 12+ & 11-)
0 ~ 5Vdc	≤ 500Ω	Output 2: Vo(V output by terminal 10+ & 11-)
1 ~ 5Vdc	≤ 500Ω	

- Accuracy:** ≤ ±0.2% of F.S. factory
≤ ±2% of F.S. after range change
≤ 0.1% of F.S.
- Linearity:** ≤ 0.1% of F.S.
- Response time:** ≤ 250msec (10%~90% of FS)
- Output ripple:** ≤ ±0.1% of F.S.
- Span adjustment:** ≤ ±10% of F.S.
- Zero adjustment:** ≤ ±10% of F.S.

Power

- Power supply:** AC/DC 20~265V, 50/60Hz
- Power consumption:** DC 4W, AC 5.0VA

Environmental

- Operating Temperature:** 0~60 °C
- Operating humidity:** 20~95% RH, Non-condensing
- Temperature Coefficient:** ≤ 100PPM/°C (0~50 °C)
- Storage temperature:** -10~70 °C
- Protection:** IP 42

Mechanical

- Dimensions:** 81.8mm x 99mm x 22.5mm
- Housing:** Self-extinguishing, black ABS, UL94V0
- Terminals:** Screw terminal, up to 2 x 2.5mm² wire
- Mounting:** 35mm DIN rail (EN50022)
- Weight:** 250g

Specification

- Electrical Safety:** IEC 61010 (Installation category 3)
- EMC:** EN 61326
- Electric Isolation:** AC 2.0KV for 1min
Between Power / Input / Output1 / Output2 / Case
- Insulation resistance:** ≥ 100MΩ at 500Vdc

ADJUSTMENT

Signal output

SIGNAL RANGE	DIP SWITCH - ZB1 (ZB1 for O/P1 & O/P2)								DIP SWITCH - ZB2 (ZB2:O/P1)				DIP SWITCH - ZB3 (ZB3:O/P2)			
	OUTPUT2				OUTPUT1				OUTPUT1				OUTPUT2			
	SW1	SW2	SW3	SW4	SW5	SW6	SW1	SW2	SW3	SW4	SW1	SW2	SW3	SW4		
0 ~ 5 V	on				on		on	on	on	on	on	on	on	on		
0 ~ 10 V	on				on		on	on	on	on	on	on	on	on		
1 ~ 5 V	on				on		on	on	on	on	on	on	on	on		
2 ~ 10 V	on				on		on	on	on	on	on	on	on	on		
0 ~ 20 mA	on				on		on	on					on	on		
4 ~ 20 mA	on				on		on	on					on	on		

DIMENSIONS

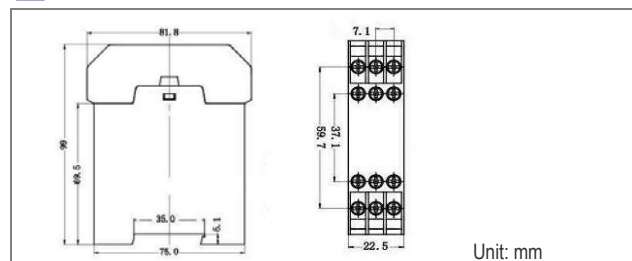

CONNECTION DIAGRAM

