

4~20mA loop Transmitters SLIMPACK

TX-CL

FEATURES

- Input 4 ~ 20 mA current loop (2 Wire) with 24Vdc excitation supply
- Output V & mA selected via terminals and 0~5V / 0~10V / 1~5V / 4~20mA / 0~20mA selected via dip switches
- 22.5 mm thin profile
- Wide power supply range AC & DC 30 ~ 264V
- CE Approved



ORDER CODING

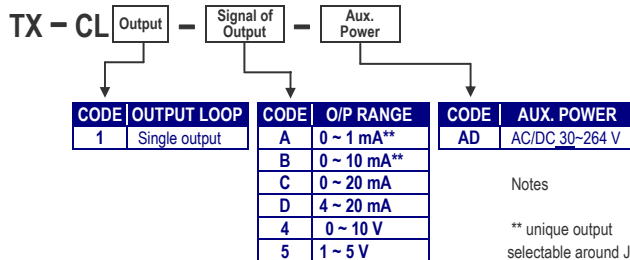

TECHNICAL DATA

Signal input

Input Range	Excitation Supply	Input Impedance
4 ~ 20 mA (2 wired) (terminals 3+ & 2-)	DC 24 V $\pm 10\%$, 22 mA	250 Ω

Analogue output (change output range by dip-switch)

Output Range	Load Resistance	Output Signal (Selected by terminals)
0 ~ 20mA _{dc}	$\leq 600\Omega$	Output 1: Io(mA output by terminal 9+ & 8-) Output 1: Vo(V output by terminal 7+ & 8-)
4 ~ 20mA _{dc}	$\leq 600\Omega$	
0 ~ 10V _{dc}	$\geq 500\Omega$	Output 2: Io(mA output by terminal 12+ & 11-) Output 2: Vo(V output by terminal 10+ & 11-)
0 ~ 5V _{dc}	$\geq 500\Omega$	
1 ~ 5V _{dc}	$\geq 500\Omega$	

- Accuracy:** $\leq \pm 0.2\%$ of F.S. factory
 $\leq \pm 2\%$ of F.S. after range change
- Linearity:** $\leq 0.1\%$ of F.S.
- Response time:** $\leq 250\text{msec}$ (10%~90% of FS)
- Output ripple:** $\leq \pm 0.1\%$ of F.S.
- Span adjustment:** $\leq \pm 10\%$ of F.S.
- Zero adjustment:** $\leq \pm 10\%$ of F.S.

Power

- Excitation supply:** DC 24V, 22mA
- Power supply:** AC/DC 30~264V, 50/60Hz
- Power consumption:** DC 4W, AC 5.0VA

Environmental

- Operating Temperature:** 0~60 °C
- Operating humidity:** 20~95% RH, Non-condensing
- Temperature Coefficient:** $\leq 100\text{PPM}/^\circ\text{C}$ (0~50 °C)
- Storage temperature:** -10~70 °C
- Protection:** IP 42

Mechanical

- Dimensions:** 81.8mm x 99mm x 22.5mm
- Housing:** Self-extinguishing, black ABS, UL94V0
- Terminals:** Screw terminal, up to 2 x 2.5mm² wire
- Mounting:** 35mm DIN rail (EN50022)
- Weight:** 250g

Specification

- Electrical Safety:** IEC 61010 (Installation category 3)
EN 61326
- EMC:** EN 61326
- Electric Isolation:** AC 2.0KV for 1min
Between Power / Input / Output / Case
- Insulation resistance:** $\geq 100\text{M}\Omega$ at 500Vdc

ADJUSTMENT

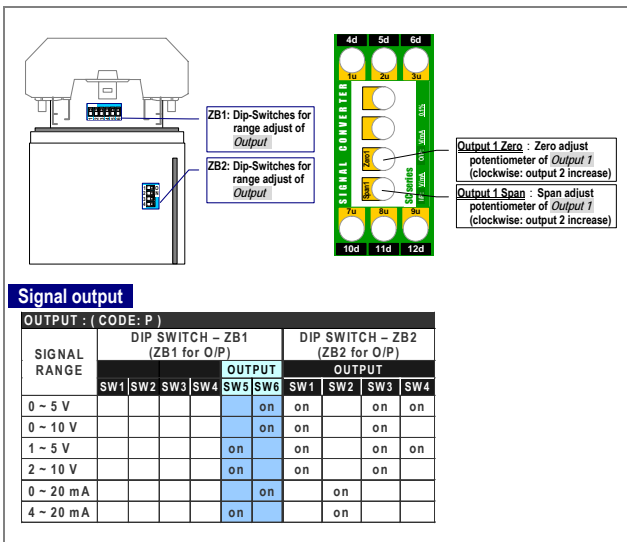

DIMENSIONS

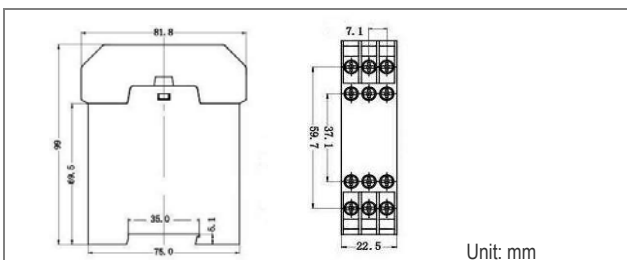

CONNECTION DIAGRAM

TX-LC Current Loop 4~20mA input (with Excitation Supply DC24V)

