

Strain Gauge Transmitters SLIMPACK

TX-SG

FEATURES

- Input modules for 0~1.0 / ~2.0 / ~3.0 / ~4.0 mV/V or 0~10.0 / ~20.0 / ~30.0 / ~40.0 mV/V programmable by dip switches
- Output V & mA selected via terminals and 0~5V / 0~10V / 1~5V / 4~20mA / 0~20mA selected via dip switches
- 22.5 mm thin profile
- Wide power supply range AC & DC 30 ~ 264V
- CE Approved



ORDER CODING

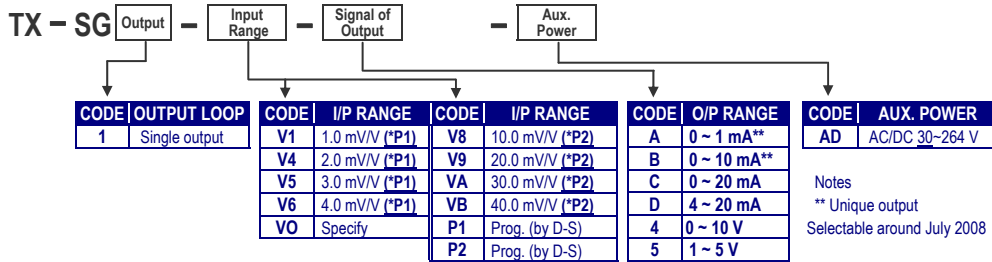

TECHNICAL DATA

Signal input (change input range by dip-switch)

Input Range	Input Signal (Selected by dip-switch on pcb)	Excitation Supply	Input Impedance
0~40 mV	P1 0~1.0/~2.0/~3.0/~4.0 mV/V	10Vdc ± 1%, 30mA	1MΩ
0~400 mV	P2 0~10.0/~20.0/~30.0/~40.0 mV/V		

Analogue output (change output range by dip-switch)

Output Range	Load Resistance	Output Signal (Selected by terminals)
0 ~ 20mA _{dc}	≥ 600Ω	Output 1: Io(mA output by terminal 9+ & 8-) Output 1: Vo(V output by terminal 7+ & 8-)
4 ~ 20mA _{dc}	≥ 600Ω	
0 ~ 10V _{dc}	≥ 500Ω	
0 ~ 5V _{dc}	≥ 500Ω	
1 ~ 5V _{dc}	≥ 500Ω	

- Accuracy:** ≤ ±0.2% of F.S. factory
≤ ±2% of F.S. after range change
- Linearity:** ≤ 0.1% of F.S.
- Response time:** ≤ 250msec (10%-90% of FS)
- Output ripple:** ≤ ±0.1% of F.S.
- Span adjustment:** ≤ ±10% of F.S.
- Zero adjustment:** ≤ ±10% of F.S.

Power

- Excitation supply:** 5Vdc or 10Vdc ± 0.1%, 30mA
- Power supply:** AC/DC 30~264V, 50/60Hz
- Power consumption:** DC 4W, AC 5.0VA

Environmental

- Operating Temperature:** 0~60 °C
- Operating humidity:** 20~95% RH, Non-condensing
- Temperature Coefficient:** ≤ 100PPM/°C (0~50 °C)
- Storage temperature:** -10~70 °C
- Protection:** IP 42

Mechanical

- Dimensions:** 81.8mm x 99mm x 22.5mm
- Housing:** Self-extinguishing, black ABS, UL94V0
- Terminals:** Screw terminal, up to 2 x 2.5mm² wire
- Mounting:** 35mm DIN rail (EN50022)
- Weight:** 250g

Specification

- Electrical Safety:** IEC 61010 (Installation category 3)
- EMC:** EN 61326
- Electric Isolation:** AC 2.0KV for 1min
Between Power / Input / Output / Case
- Insulation resistance:** ≥ 100MΩ at 500Vdc

ADJUSTMENT

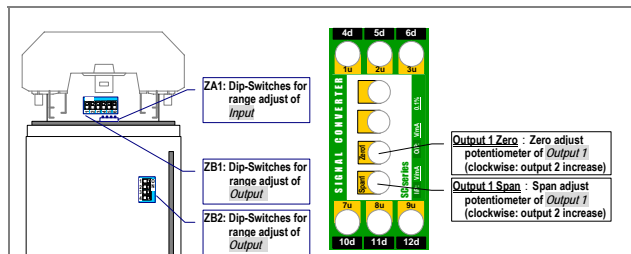

Signal input

mV / V INPUT : (CODE: P1)				mV / V INPUT : (CODE: P2)							
SIGNAL RANGE	DIP SWITCH (ZA1)	SW1	SW2	SW3	SW4	SIGNAL RANGE	DIP SWITCH (ZA1)	SW1	SW2	SW3	SW4
0 ~ 1.0 mV/V	on					0 ~ 10.0 mV/V	on				
0 ~ 2.0 mV/V		on				0 ~ 20.0 mV/V		on			
0 ~ 3.0 mV/V			on			0 ~ 30.0 mV/V			on		
0 ~ 4.0 mV/V				on		0 ~ 40.0 mV/V				on	

Signal output

OUTPUT : (CODE: P)														
SIGNAL RANGE	DIP SWITCH - ZB1 (ZB1 for O/P)				DIP SWITCH - ZB2 (ZB2 for O/P)									
	SW1	SW2	SW3	SW4	SW5	SW6	SW1	SW2	SW3	SW4				
0 ~ 5 V					on		on			on				
0 ~ 10 V					on		on			on				
1 ~ 5 V					on		on			on				
2 ~ 10 V					on		on			on				
0 ~ 20 mA					on				on					
4 ~ 20 mA					on				on					

DIMENSIONS

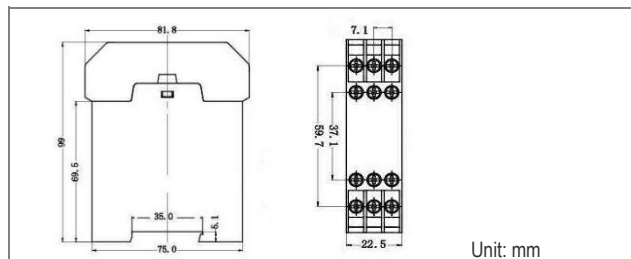

CONNECTION DIAGRAM

TX-SG Load Cell mV/V input

